

GPZA - GPZ

2x18" Active/Passive Subwoofers + 2x12" Array Element System



Heavy duty 2x18" subwoofer combined with two metal frame GH12 12" coaxial featuring the K-array™ SAT® technology.

The active GPZA system is powered by a 4-channel amplifier module delivering up to 1500 W per channel @ 4 Ω: the built in amp module makes the GPZA capable of driving a GPZ passive system in a stereo configuration.

The GPZA powered system features Powersoft™ DSP with Ethernet connectivity for remote tuning and management with the Armonia™ control software.

Designed for high performance outdoor/indoor applications both for rental and permanent installations for touring, large auditorium, stadia, theme parks and clubs. Weather resistant rugged box.

Frequent Applications

Event Productions	Fitness & Wellness
Concerts & Live Events	Stadiums & Sports Venues
Corporate Events	Houses of Worship

Handling & Finishes

Dimensions (WxHxD)	1035 x 2040(min) x 600 mm (40,75 x 80,31 x 23,6 in)
Weight	GPZA: 90kg (198.4 lb) GPZ: 86,6 (190.9 lb)
Material	Subwoofer: Birch Plywood Satellites: Stainless steel
Color	Black 

GPZA

Powered 2x 18" Sub 2x12" Array Element System

General	
Type	Powered Sub + Satellite system
Transducers	SUB: 2x 18" woofer TOP: 2x 12" coaxial woofer with 1" comp. driver
Frequency Response	30 Hz - 20 kHz (-6dB)
Max SPL ¹	137 dB
Coverage	V. 30° H. 90°
Amp Module	4-channel Class-D
Output Power	4x 1500 W @ 4 Ω
Power Consumption	500W Rated Load (1/8 Max Output Power)
Operating Voltage	100-240V AC, 50-60 Hz
DSP features	Remote control and tuning Input and Output Delay Parametric input EQ Output parametric IIR filters
Connectors	RJ45 for remote control 2x Combo XLR Input 2x SpeakON Output 1x PowerCon True AC MAINS
Controls	Volume potentiometer Preset selector Ethernet remote control through Powersoft™ ArmoniaPlus Software

¹ Maximum SPL is calculated using a signal with crest factor 4 (12dB) measured at 1 m.

GPZ

Passive 2x 18" Sub 2x12" Array Element System

General	
Type	Passive Sub + Satellite system
Transducers	SUB: 2x 18" woofer TOP: 2x 12" coaxial woofer with 1" comp. driver
Frequency Response	30 Hz - 20 kHz (-6dB)
Max SPL ¹	137 dB
Coverage	V. 30° H. 90°
Power Handling	SUB: 1500W TOP: 400W
Nominal Impedance	SUB: 4 Ω TOP: 32 Ω each satellites
Connectors	2x SpeakON (paralleled) SUB 2+/2- TOP: 1+/1-

¹ Maximum SPL is calculated using a signal with crest factor 4 (12dB) measured at 1 m.

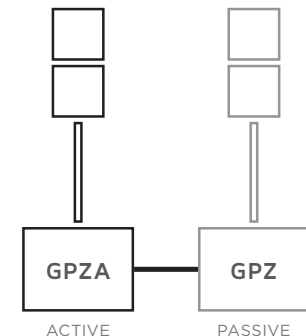

User Tip:
optimize the cost and combine the active and passive systems whether it is for stereo configurations or if you prefer to extend the cluster.

Assembly

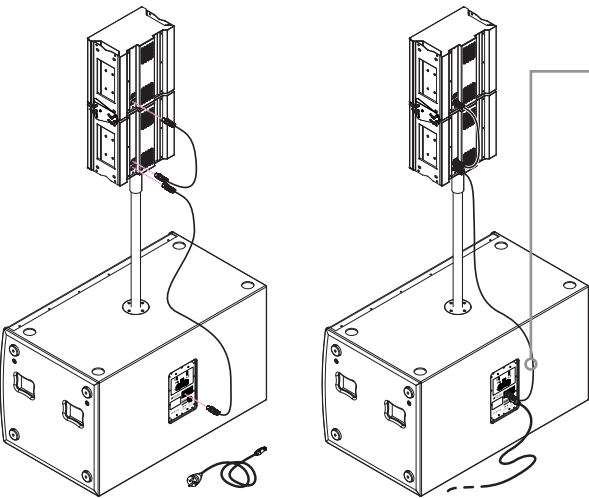
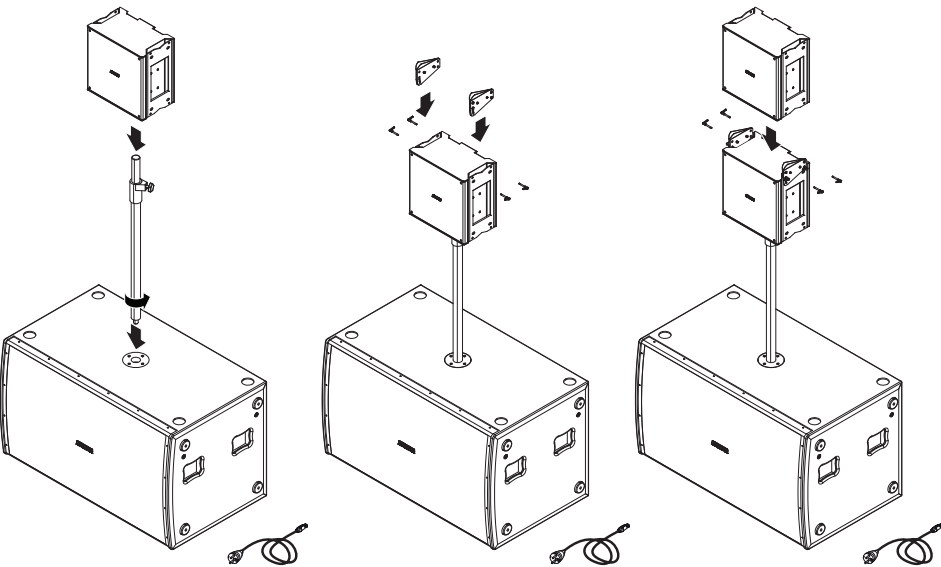

TOP Speaker
SpeakON A port

#	Preset Name
1	KGEAR optimized
2	Linear response
3	Subwoofer boost
4	Mid-high boost
Default	KGEAR optimized

GPZA rear panel

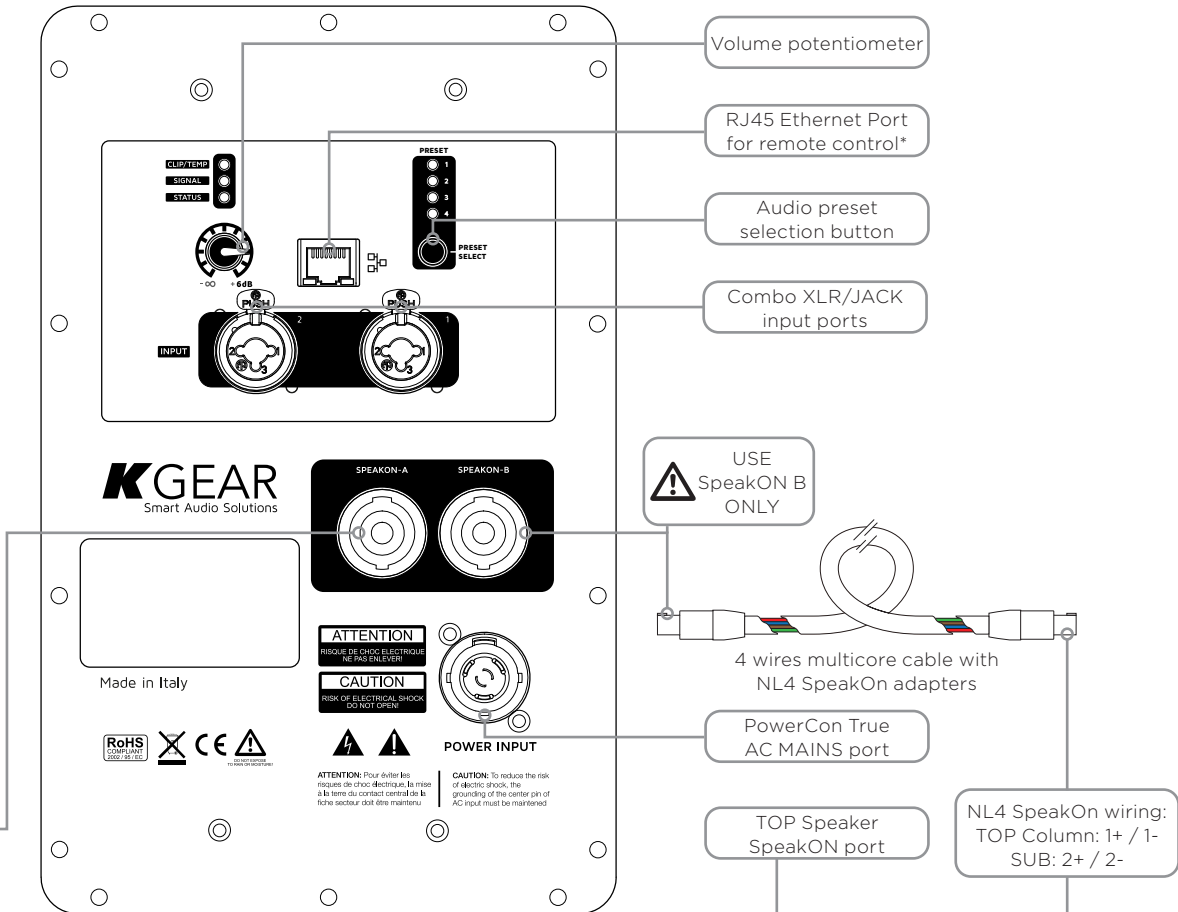

*ArmoniaPlus is the software for fine tuning and monitoring the GP18A loudspeakers system. Download ArmoniaPlus from Powersoft website:
<https://www.powersoft.com/en/software/armoniaplus-2-0>

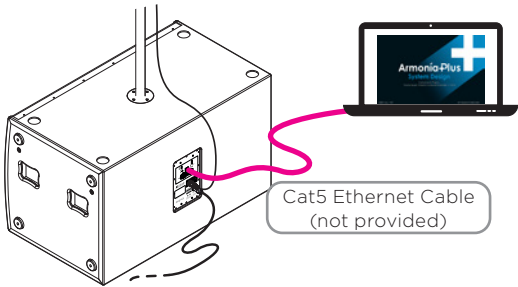

GPZ rear panel

