

**GP12A - GP12**  
**12" Active/Passive Subwoofers + 16x2" Modular Column System**



Heavy duty 12" subwoofer combined with 2 modular 2" transducer array elements featuring PAT® technology by K-array™. The GP12A powered system can drive a GP12 passive system in a stereo configuration.

The GP12A features Powersoft™ DSP and power module with Ethernet remote control through Armonía™ control software.

Designed for high performance outdoor/indoor applications both for rental and permanent installations for touring, live bands, auditorium, and clubs. High performance to size/weight ratio featuring easy and fast setup possibility.

Frequent Applications	
Parties	Karaoke
Private events	DJ set
Corporate events	Weddings

Handling & Finishes	
Dimensions (WxHxD)	545 x 600 x 2030 mm (21.48 x 23.62 x 79.9 in)
Weight	GP12A: 24,6 kg (54.23 lb) GP12: 21,8 kg (48 lb)
Material	Subwoofer: Birch Plywood Column: ABS
Color	Black 

**GP12A**  
**Powered 12" Sub**  
**16x2" Modular Column System**

General	
Type	Powered Sub + Column line array system
Transducers	SUB: 12" woofer TOP: 2 modules with 8x2" ferrite magnet woofers
Frequency Response	30 Hz - 20 kHz (-6 dB)
Max SPL <sup>1</sup>	123 dB (peak)
Coverage	V. 25°   H. 140°
Amp Module	4-channel Class-D
Output Power	4x 750 W @ 4 Ω
Power Consumption	300W Rated Load (1/8 Max Output Power)
Operating Voltage	100-240V AC, 50-60 Hz
DSP features	Remote control and tuning Input and Output Delay Parametric input EQ Output parametric filters
Connectors	RJ45 for remote control 2x Combo XLR Input 2x SpeakON Output 1x PowerCon True AC MAINS
Controls	Volume potentiometer Preset selector Remote control through Powersoft ArmoniaPlus Software

<sup>1</sup> Maximum SPL is calculated using a signal with crest factor 4 (12dB) measured at 4 m then scaled at 1 m.

**GP12**  
**Passive 12" Sub**  
**16x2" Modular Column System**

General	
Type	Passive Sub + Column line array system
Transducers	SUB: 12" woofer TOP: 2 modules with 8x2" ferrite magnet woofers
Frequency Response	30 Hz - 20 kHz (-6 dB)
Max SPL <sup>1</sup>	123 dB (peak)
Coverage	V. 25°   H. 140°
Power Handling	SUB: 600W COLUMN: 500W
Nominal Impedance	SUB: 4Ω COLUMN: 16 Ω each segment
Connectors	2x SpeakON (paralleled) COLUMN: 1+, 1- SUB 2+, 2-

<sup>1</sup> Maximum SPL is calculated using a signal with crest factor 4 (12dB) measured at 4 m then scaled at 1 m.

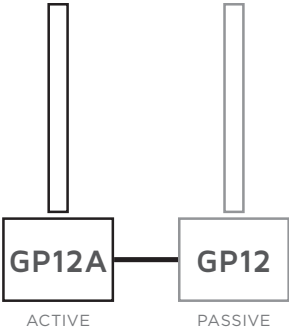

User Tip:  
optimize the cost  
and combine the  
active and passive  
systems whether  
it is for stereo  
configurations or  
if you prefer to  
extend the cluster.

Assembly

GP12A rear panel

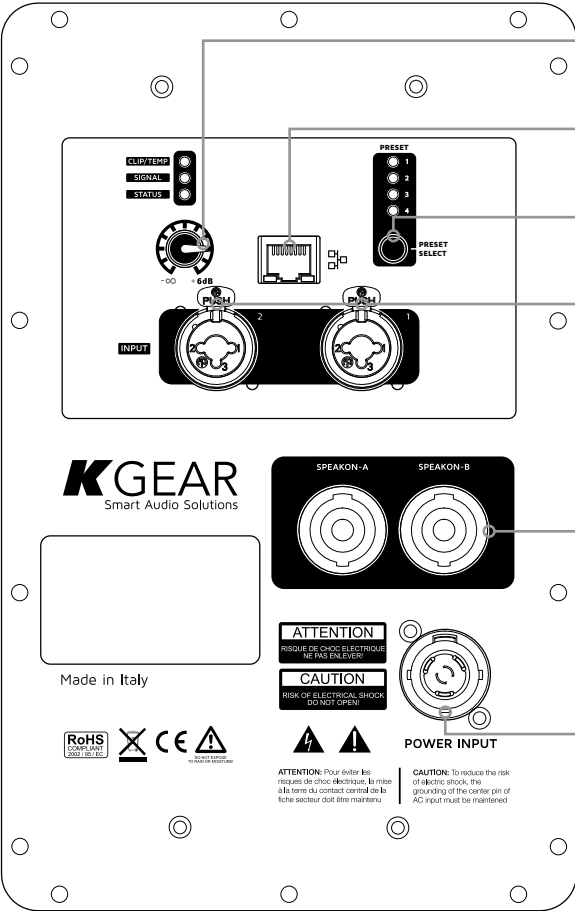
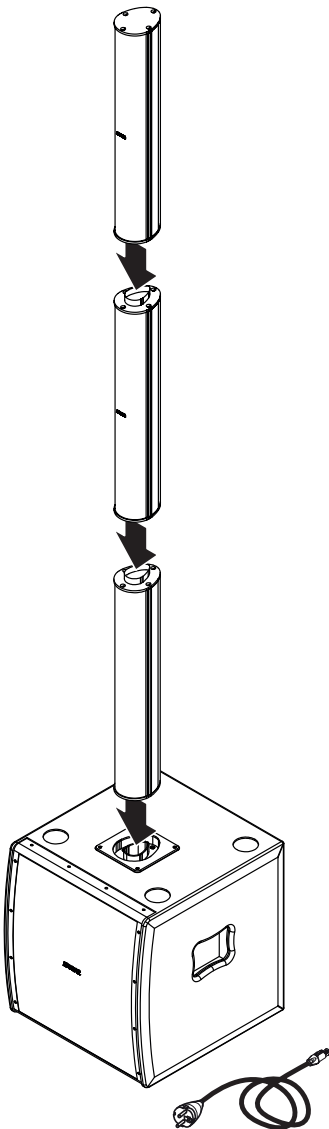

Volume potentiometer

RJ45 Ethernet Port for remote control\*

Audio preset selection button

Combo XLR/JACK input ports

USE SpeakON B ONLY

4 wires multicore cable with NL4 SpeakOn adapters

PowerCon True AC MAINS port

#	Preset Name
1	KGEAR optimized
2	Linear response
3	Subwoofer boost
4	Mid-high boost
Default	KGEAR optimized

GP12 rear panel

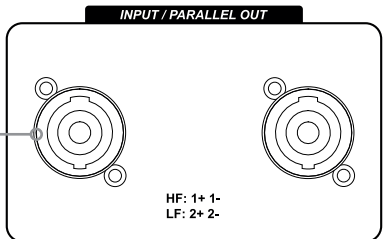

HF: 1+ 1-  
LF: 2+ 2-

NL4 SpeakOn wiring:  
TOP Column: 1+ / 1-  
SUB: 2+ / 2-

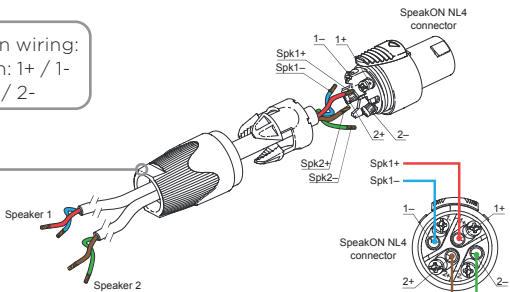

\*ArmoniaPlus is the software for fine tuning and monitoring the GP18A loudspeakers system. Download ArmoniaPlus from Powersoft website:  
<https://www.powersoft.com/en/software/armoniaplus-2-0>

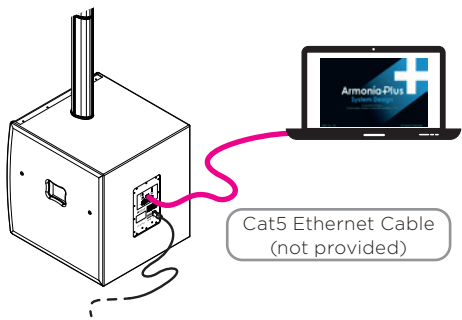

Cat5 Ethernet Cable (not provided)

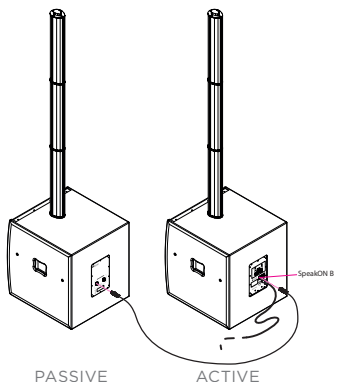

PASSIVE

ACTIVE