

GF42I - GF42TI

Passive 4x2" Line Array Column Speaker - Ppassive with transformer

GF42AI

Active 4x2" Line Array Column Speaker



GF42I, GF42TI, GF42AI are the smallest and minimalist line array elements of the GF Family. With a new stainless steel grille and new L-bracket system included, the speakers are now upgraded in a MKI version that makes the series more suitable for outdoor installations.

Comprised of 4x2" ferrite magnet woofers closely-spaced into a recycled ABS enclosure, all this columns benefit from K-array™ PAT (Pure Array Technology) to combine all the advantages of a pure line array such as long throw and dispersion control into an ultra-compact box design.

These columns speakers are the perfect solution for speech reproduction: thanks to a great directivity and a narrow vertical dispersion, they ensure high definition and a great intelligibility, as well as music reproduction when coupled with a KGEAR subwoofer.

GF42I is a 100W line array element with selectable impedance: low Z - 16 Ω / high Z- 64 Ω .

GF42TI has the feature of an internal transformer and it is compatible with high voltage lines at 70V or 100V with different power taps: 4/8/16/32 W @ 100V or 2/4/8/16 W @ 70V.

GF42AI is an active speaker with a built-in amplifier module comprised of a balanced line input, a mute contact and an auto ON-OFF switch with selectable thresholds, plus a speaker output to connect another KGEAR speaker or passive subwoofer from KGEAR GS family.

GF42I, GF42TI, GF42AI come in black and white (GF42WI, GF42AWI, GF42TWI)



Wall mount L-brackets (included in the package)

GF42I- GF42AI - GF42TI comes with 2x practicals on-wall mounting brackets, to provide different angles for fixed installations.



G-IPCAP1 - G-IPCAP2 (not included)

G-IPCAP1 and G-IPCAP2 are two IP sealing protection cap to be applied at the rear panel of the speaker to protect the connectors from water, salt and chlorine.

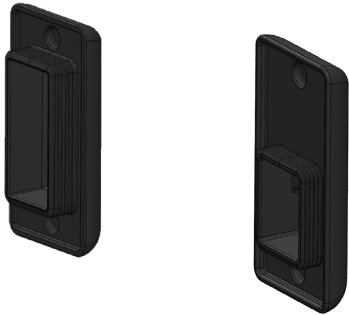

Mechanical Drawings

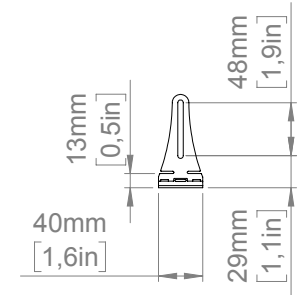
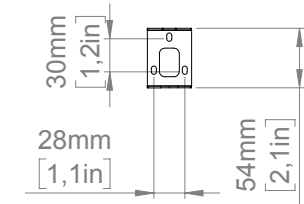
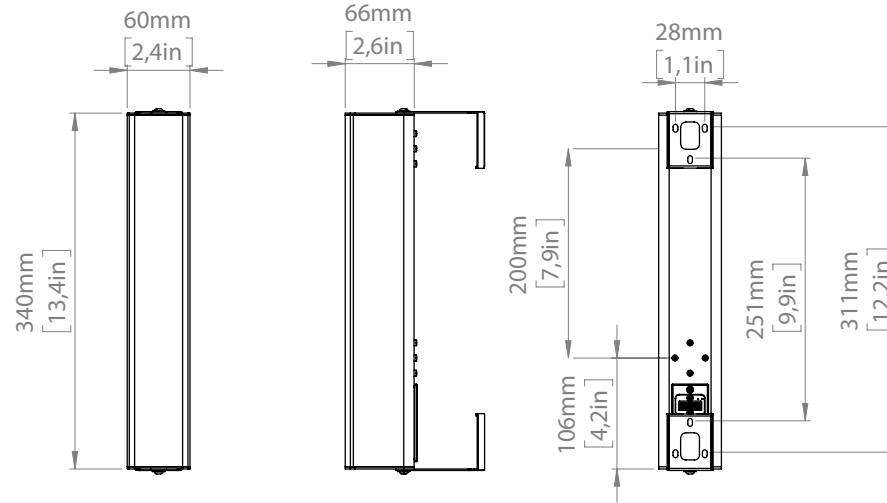
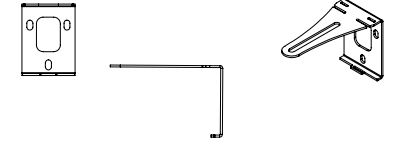
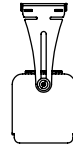

GF42I

GF42TI

GF42AI

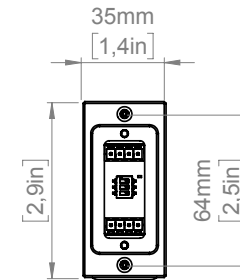
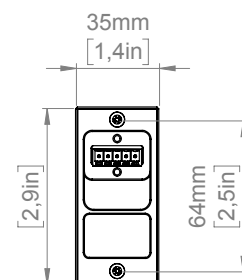
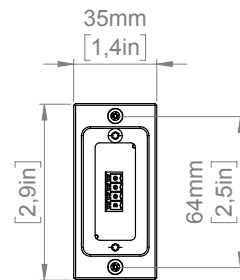

GF42I

Technical specifications
Type Passive loudspeaker
Transducer 4 x 2" ferrite magnet woofer
Frequency Response ¹ 160 Hz - 20 kHz (-6dB)
Max SPL ² 111 dB (peak)
Power Handling 100 W
Coverage V.25 I.H.90°
Connectors 1x Phoenix connector (4-pin Euroblock)
Nominal Impedance 8Ω - 32Ω
IP Rating IP55
Handling & Finishes
Dimensions (WxLxH) ⁴ 60 x 340 x 66 mm (2,36 x 13,4 x 2,6 in)
Weight 0.8 kg (1.76 lb)
Material ABS
Color Black - White (GF42W)

1 With dedicated preset

2 Maximum SPL is calculated using a signal with crest factor 4 (12 dB) measured at 8 m then scaled at 1 m

3 With dedicated G-IPCAP1

1 With dedicated preset

2 Maximum SPL is calculated using a signal with crest factor 4 (12 dB) measured at 8 m then scaled at 1 m

3 With dedicated G-IPCAP1 accessory

4 Brackets not included in measures - fore more details see the mechanical drawings.

GF42AI

Technical specifications
Type Active loudspeaker
Transducer 4x2" neodymium magnet full-range driver
Frequency Response ¹ 160 Hz - 20 kHz (-6dB)
Max SPL ² 105 dB
Coverage V.25 I.H.90°
Connectors 2x Phoenix connector (4-pin euroblock) Balanced line in Mute Contact Power out 24V DC IN (power supply not included)
Controllers Auto ON/OFF with selectable threshold
Amp Module 1-channel Class D amplifier
Output Power 100W @ 2Ω (24V power)
Power Consumption 30W Power Load 1/8 Max Power
Protections Thermal Protections (Power-Limiting - Thermal Shutdown) Short - circuit/overload output protections
Operating Range 12-24 V DC
IP Rating ³ IP55
Handling & Finishes
Dimensions (WxLxH) ⁴ 60 x 340 x 66 mm (2,36 x 13,4 x 2,6 in)
Weight 0.8 kg (1.76 lb)
Material Stainless Steel
Color Black - White (GF42AW)

GF42TI

Technical specifications
Type Passive loudspeaker with Transformer
Transducer 4 x 2" ferrite magnet woofer
Frequency Response ¹ 160 Hz - 20 kHz (-6dB)
Max SPL ² 102 dB
Rated Power 100 W
Transformer Taps 2/4/8/16W 100V - 1/2/4/8W @ 70V
Coverage V.25 I.H.90°
Connectors 1x Phoenix connector (5-pin Euroblock)
Handling & Finishes
Dimensions (WxLxH) 60 x 340 x 66 mm (2,36 x 13,4 x 2,6 in)
Weight 1.3 kg (2.87 lb)
Material ABS
Color Black - White (G42TW)

1 With dedicated preset

2 Maximum SPL is calculated using a signal with crest factor 4 (12 dB) measured at 8 m then scaled at 1 m