

GP18A - GP18
18" Active/Passive Subwoofers + 24x2" Modular Column System



Heavy duty 18" subwoofer combined with 3 modular 2" transducer array elements featuring PAT® technology by K-array™. The GP18A powered system can drive a GP18 passive system in a stereo configuration. The GP18A features Powersoft™ DSP and power module with Ethernet remote control through Armonía™ control software. Designed for high performance outdoor/indoor applications both for rental and permanent installations for touring, live bands, auditorium, and clubs. High performance to size/weight ratio featuring easy and fast setup possibility.

Table with 2 columns: Application/Feature and Details. Rows include Frequent Applications (Parties, Private events, Corporate events), Handling & Finishes (Dimensions, Weight, Material, Color).

GP18A
Powered 18" Sub
24x2" Modular Column System

Table with 2 columns: General and Specifications. Rows include Type, Transducers, Frequency Response, Max SPL, Coverage, Amp Module, Output Power, Power Consumption, Operating Voltage, DSP features, Connectors, Controls.

1 Maximum SPL is calculated using a signal with crest factor 4 (12dB) measured at 4 m then scaled at 1 m.

GP18
Passive 18" Sub
24x2" Modular Column System

Table with 2 columns: General and Specifications. Rows include Type, Transducers, Frequency Response, Max SPL, Coverage, Power Handling, Nominal Impedance, Connectors.

1 Maximum SPL is calculated using a signal with crest factor 4 (12dB) measured at 4 m then scaled at 1 m.

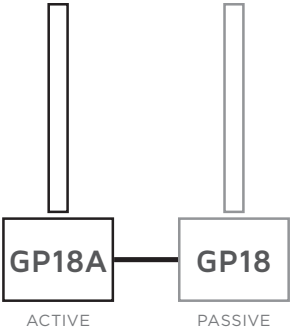

User Tip: optimize the cost and combine the active and passive systems whether it is for stereo configurations or if you prefer to extend the cluster.

Assembly

GP18A rear panel

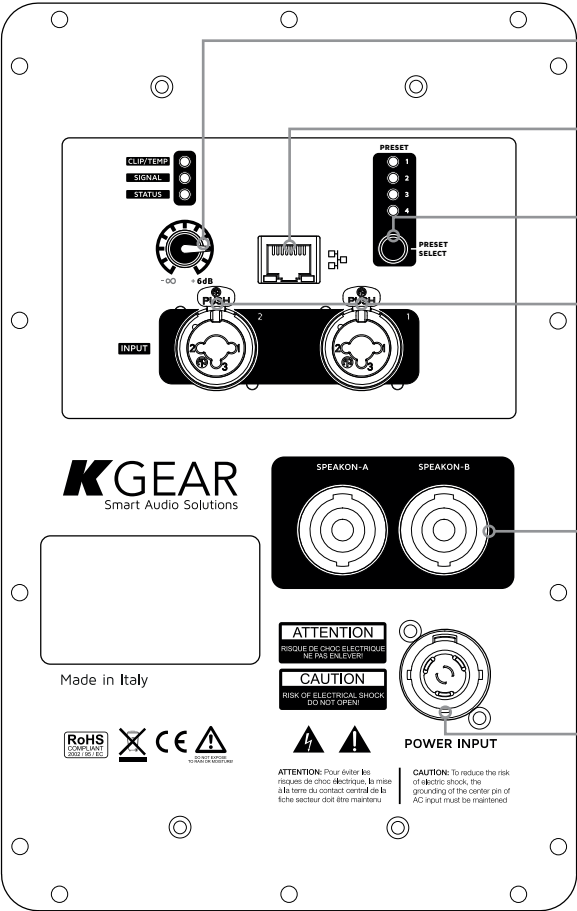
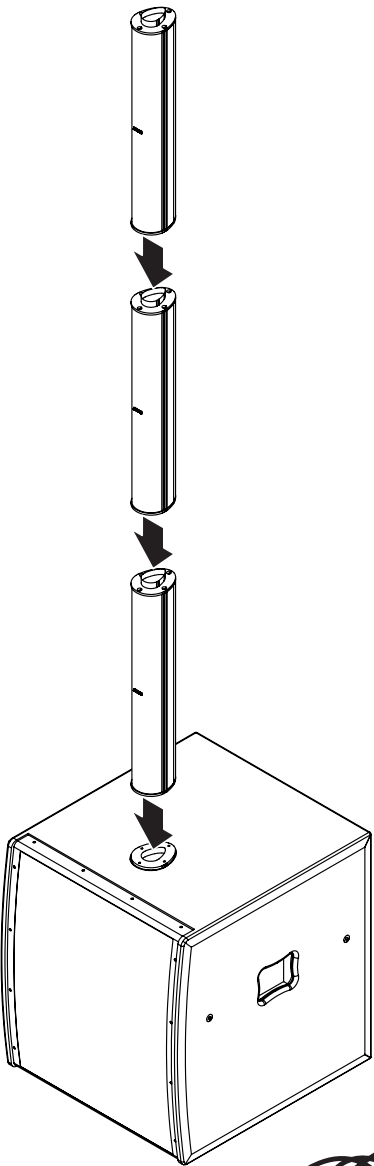

Volume potentiometer

RJ45 Ethernet Port for remote control*

Audio preset selection button

Combo XLR/JACK input ports

USE SpeakON B ONLY

4 wires multicore cable with NL4 SpeakOn adapters

PowerCon True AC MAINS port

#	Preset Name
1	KGEAR optimized
2	Linear response
3	Subwoofer boost
4	Mid-high boost
Default	KGEAR optimized

GP18 rear panel

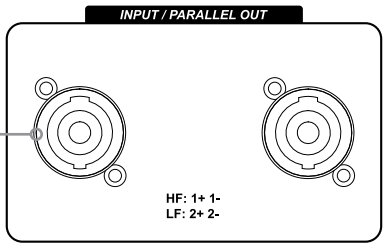

NL4 SpeakOn wiring:
TOP Column: 1+ / 1-
SUB: 2+ / 2-

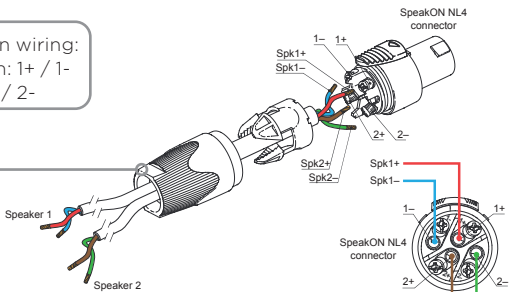

*ArmoniaPlus is the software for fine tuning and monitoring the GP18A loudspeakers system. Download ArmoniaPlus from Powersoft website:
<https://www.powersoft.com/en/software/armoniaplus-2-0>

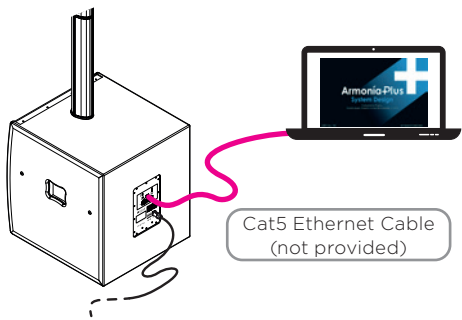

Cat5 Ethernet Cable (not provided)

